

# Use and Care Guide

ProClean

## Dryer Duct Lint Trap

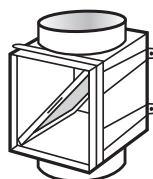

### TOOLS REQUIRED



Wire Cutters



Utility Knife

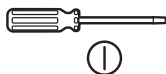

Screwdriver  
or 5/16" Nutdriver

### HARDWARE REQUIRED (NOT INCLUDED)



Screws (4)

## Installation

### 1 CUTTING THE EXISTING DUCT

- Cut the existing duct attached to the dryer about 10 in. above the top control panel of the dryer.

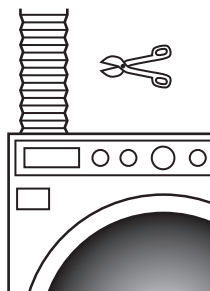

### 2 ATTACHING THE DUCT TO THE TOP OF UNIT

- Slide the free end of the duct which leads outside, over the top collar of the lint trap unit. Secure it with one of the metal clamps provided.

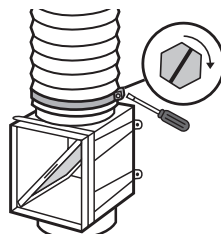

### 3 ATTACHING THE DUCT TO THE BOTTOM OF UNIT

- Slide the free end of the remaining duct coming from the dryer, over the bottom collar of the lint trap unit. Secure it with the other clamp.

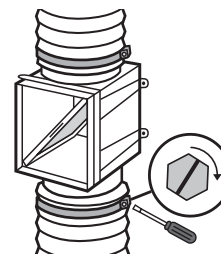

### 4 INSTALLING THE UNIT TO THE WALL

- Locate a stud behind the wall or mount directly to the wall using drywall plugs and screws (not provided).

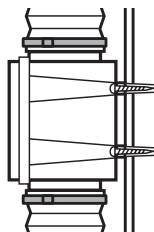

### 5 CLEANING THE LINT SCREEN AFTER EACH USE

- Open the door of the lint trap unit, remove the screen and clean off the lint.

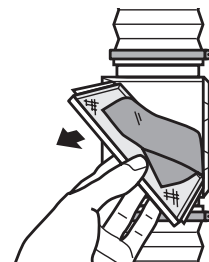

## Note

For maximum efficiency, clean the lint filter after each use.

## Warranty

### WHAT IS COVERED

All merchandise is warranted to be free from defects in workmanship and material for one year from the date of purchase. This includes normal wear and performance failure on items. The manufacturer will replace or repair at their option.

### WHAT IS NOT COVERED

This warranty only covers normal wear and performance failure. It does not cover any malfunction, performance failure, or defect arising from the misuse, abuse, neglect, or modification of the product. Any damage or malfunction inflicted upon the product by the user or other external sources, or any failure to comply with the warnings and instructions, is not covered.

For further assistance visit [www.DundasJafine.com](http://www.DundasJafine.com).